

User Manual

D200

service@lingdu.us

Response in just 12 hours

Product	Dashcam
Manufacturer	Dongguan Lingdu Electronic Technology Co., Ltd
Address	1 Longcheng Street, Qingxi Town, Dongguan City, Guangdong Province, China
Product Warranty	One-Year Limited Warranty
Customer Support	service@lingdu.us

CE FCC RoHS
Made in China

FCC ID: 2ASWVD200

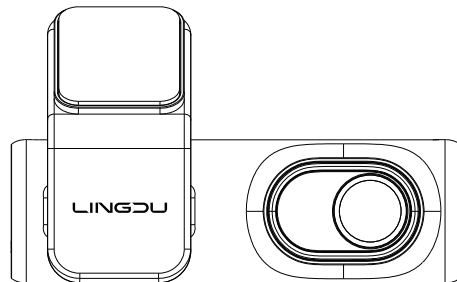

LINGDU

Table of Contents

English	01
---------------	----

Index

1. Customer Service	2
2. Important Safety Information	3
3. In The Box	5
4. Specification	6
5. Product Diagram	7
6. Getting Started	10
7. Installation	12
8. Playing Video Files Using Your Smartphone	15
9. General Setting	25
10. Playing Video Files Using Your Computer.....	31
11. Firmware Update	33
12. Voice Prompts	34
13. FAQ	36
14. Notice	38

1. Customer Service



Defective or damaged item?
Inaccurate description?
Missing parts or accessories?
Performance or quality not adequate?
Wrong item was sent?

service@lingdu.us

Response in just 12 hours

Contact us before returning the item.
We will help you resolve any issue asap.



Note:

1. A 64GB microSD card is provided with the LINGDU dashcam when you purchase the product. Be sure to format your microSD card with your dash cam for the first time use.
2. Please ALWAYS connect with power when using. As it is built in Super Capacitor (Only has a 1mAh Lithium Metal Battery used to memorize time).

2. Important Safety Information

Thank you for purchasing this LINGDU dashcam.

This instruction manual contains information on how to operate your dashcam.

Before using your dashcam, we recommend that you read through this manual to ensure correct usage. To improve the performance of the product, the contents of this manual are subject to change without prior notice.

·Do not disassemble, repair, or modify the product yourself.

Doing so may cause fire, electric shock, or malfunction. For internal inspection and repair, contact the service center.

·If any foreign matter gets inside the product, detach the power cord immediately.

Contact the service center for repair.

·Do not adjust the product while driving.

Doing so may cause an accident. Stop or park your car in a safe place before installing and setting up the product.

·Do not install the product in a location where the product can interfere with the driver's field of vision.

Doing so may cause an accident.

·Do not use a damaged or modified power cord. Only use the cords provided by the manufacturer.

Damaged or modified power cords may cause an explosion, fire, or malfunction.

·Do not operate the product with wet hands.

Doing so may cause electric shock.

·Do not install the product in an environment with high humidity, or combustible gases or liquids.

Doing so may cause an explosion and/or fire.

·Do not leave the product near infants, children, or pets.

There is a risk of them swallowing small components, and/or their saliva may get into the product, causing an explosion due to a short circuit.

·Do not spray water or wax directly onto the product while cleaning the inside of the car.

Doing so may cause fire, electric shock, or malfunction.

·If smoke or an unusual smell is emitted from the power cord, detach the power cord immediately.

Contact the service center or your distributor.

·Keep the terminals of the power cord clean.

Failure to do so may cause excessive heat and fire.

·Use the correct input voltage.

Failure to do so may cause explosion, fire, or malfunction.

·Plug in the power cord firmly so that it cannot easily be disconnected.

Failure to do so may cause fire.

·Do not cover the product with any material.

Doing so may cause external deformation of the product or fire. Use the product and peripherals in a well-ventilated location.

3. In The Box

Check the box for each of the following items before installing the dash cam.

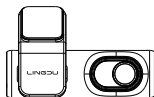

Front dash camera ×1



Rear camera
(6M/20ft)×1



Electrostatic films ×2



Car charger ×1



Type-C USB Power
cable (3.5M/12ft)×1



Storage card ×1



Cable clips ×5
Pry tool ×1

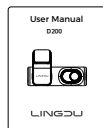

User manual ×1



Note:

1. To improve the performance of the product, the contents of this manual are subject to change without prior notice.

4.Specification

Model	D200
Aperture	F=1.8
Color	Black
Language	English / 日本語 / Deutsch / Français / Español / Italiano / Русский
Memory	Max support 128GB (U3 Speed, only one 64GB microSD in the dash cam)
Video Code	H.264
Photo Format	JPG
Video Compression Mode	MP4
Video Resolution	1CH: 3K 3200*1800P 30fps (Default) 2K 2560*1440P 30fps 1080P 1920*1080P 30fps 2CH: 2560*1440P 30fps+1920*1080P 30fps (Default) 1920*1080P 30fps+1920*1080P 30fps
GPS Track	Built-in, LINGDU GPS Player
WiFi	Built-in
Battery	Built-in Super Capacitor
Power Interface	5V/2.5A
Operation Temperature	-20°C to 70°C (-4°F to 158°F)

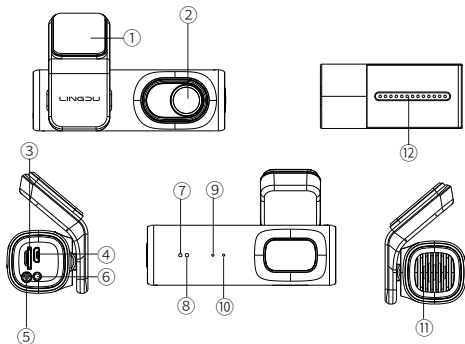

5. Product Diagram

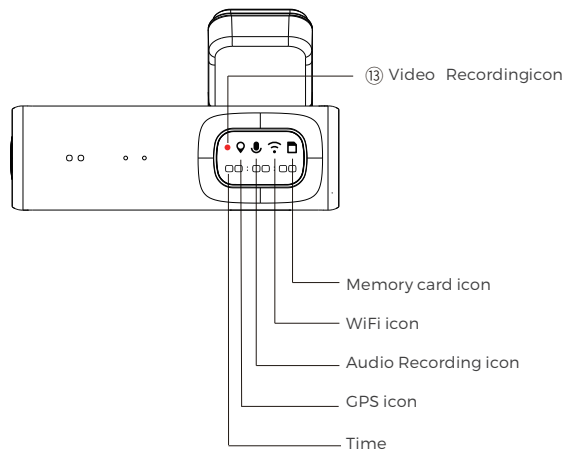

#	Description
1	Sticker Mount
2	Front Camera
3	Micro-SD Card Slot
4	TYPE-C Charging Port
5	WiFi Key- Short Press to turn on/off WiFi. Double click to turn on/ off recording. Press and Hold for 3 seconds to lock the video. Press and Hold for 8 seconds to set to Format Micro-SDCard and default settings.

6	Rear Camera Slot (AV-IN)
7	Recording LED Indicator
8	GPS LED Indicator
9	Mic-phone
10	Reset Button
11	Speaker
12	Rear Camera



	Color	Status
⑬ REC	 Blinking	Recording normal video
	 Blinking	Recording locked video



Note:

The clock is displayed during normal recording, while the recording duration of the locked video segment is displayed during emergency recording.

6. Getting Started

The camera is designed to power up and record automatically when it receives power. Then saves the video record and turns off automatically when the car shuts off.

1. Auto Power ON/OFF:

Plug car charger to cigarette lighter socket. When the car engine is on, dash cam will turn ON and start recording automatically. When the car key is turned to LOCK position, dash cam automatically saves the recording and turns OFF.

2. Manual Power ON/OFF

Manually Turn ON: Press the power button once. Manually Turn OFF: Press and hold the power button for at least 2 seconds.



Note:

1. A 64GB microSD card is provided with the LINGDU dashcam when you purchase the product. Be sure to format your microSD card with your dash cam for the first time use.
2. Please ALWAYS connect with power when using. As it is built in Super Capacitor (Only has a 1mAh Lithium Metal Battery used to memorize time).
3. Setting Date & Time: Please calibrate the date/time based on your location under the TIME ZONE SETTING by going to APP system settings menu, please refer to page EN-16.

4. Some trucks/cars's 12V cigarette outlet is always HOT, which means it provides constant power even when the car is turned off and locked. If this is the case for your vehicle, then the auto

ON/OFF feature will not work. And if you leave the camera continuously recording when the car is turned off, then it will drain your car/truck's battery and you might not have enough power to start your car for next time. To remedy this situation,you can do one of the two options:

①Hardwire your dash cam to your car's fuse box with 3-Lead Auto Trigger Hardwire Kit.

②Change the connection in the fuse box for your 12V outlet to socket which only supplies power when car key is turned to ACC or ON position.

7. Installation

Install the front camera behind the rear view mirror. Install the rear camera at the top of the back windshield. Remove any foreign matter and clean and dry the windshield before installation.

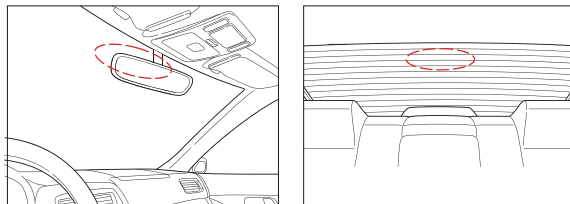

1. Turn off the engine, gently push the card into the slot until it locks into place.(Please using class 10 or above high-speed U3 micro-SD card)
2. Find a suitable place on windshield where don't obstruct the driver's field of vision and remove any foreign matter and clean and dry the windshield before installation.Tear off the protective layer of the electrostatic sticker and adhere the electrostatic sticker to the windshield to prevent mark/glue on your windshield after removing it.
3. Peel off the protective film from the double-sided tape and attach the front camera to the electrostatic sticker.Adjust the angle of the lens by adjusting the bracket of the front camera.

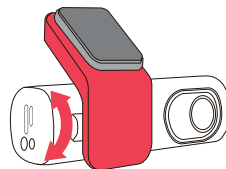

4. Peel off the protective film from the double-sided tape and attach the rear camera to the rear windshield. Adjust the angle of the lens by rotating the body of the rear camera, connect the front camera and the rear camera.

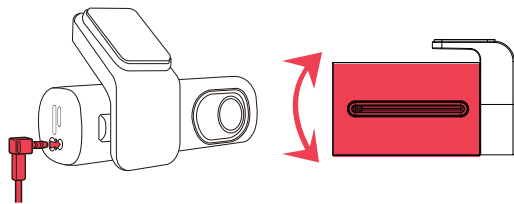

5. Use the pry tool to lift the edges of the rubber window sealing and molding and tuck in the rear camera connection cable.

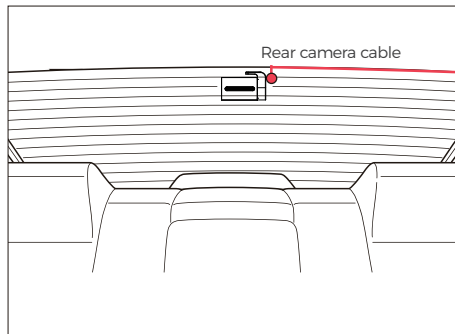

6. Plug the cigarette lighter power cable into the cigarette lighter socket and the front camera. Use the pry tool to lift the edges of the windshield trim/molding and tuck in the power cord.

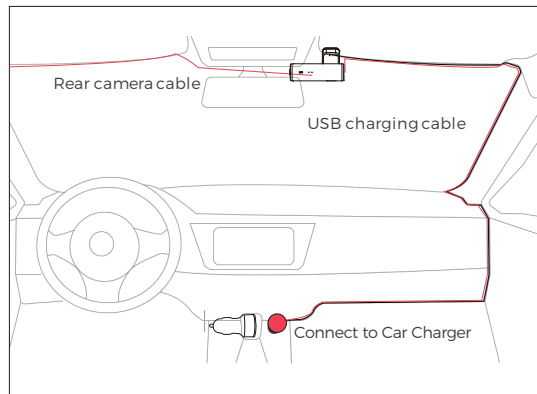

7. Turn on the engine. The dashcam will power up and start recording. Video files are stored on the microSD card. Turn off the engine. The dashcam will automatically stop recording and power down.

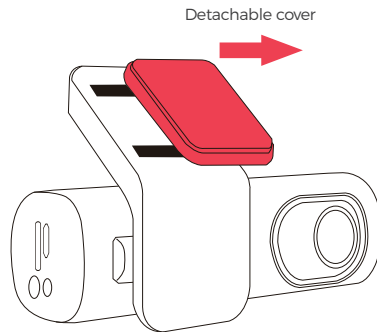

8. Playing Video Files Using Your Smartphone

8.1 Check real-time video using your smartphone

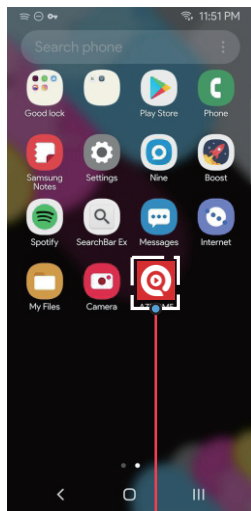

1 Search for the LINGDU app in the Google Play Store or Apple App Store and install it on your smartphone.



Scan QR code to download LINGDU APP

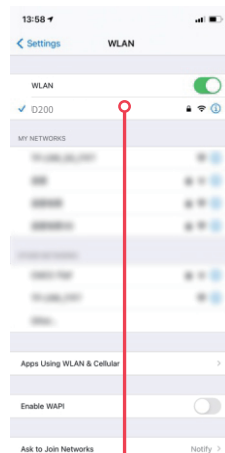

2 Go to Phone's Settings > WiFi > Select WiFi of the dash cam. After it's connected to the WiFi, it will say 'No Internet Connection' which was normal. Because dash cam WiFi is ONLY for video/photo transfer function, NOT made to broadcast footage over the cloud or internet, please ignore the prompt.

WiFi Name SSID: LINGDU-D200_*****

Default PASSWORD: 12345678

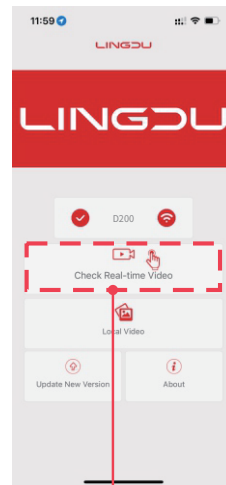

3 There will show dash cam model D200 when connect successfully. Press "Check Real-time Video" to live video preview interface.

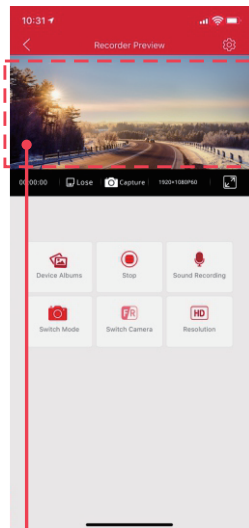

4 Now you can view the video currently being recorded real-time by connecting your smartphone to the dashcam via Wi-Fi Direct.

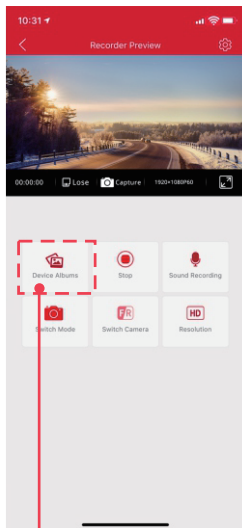

5 Please STOP recording first, then press the 'Device Album' to get Photo, Video, Emergency files.

8.2 Download the video files into your smartphone

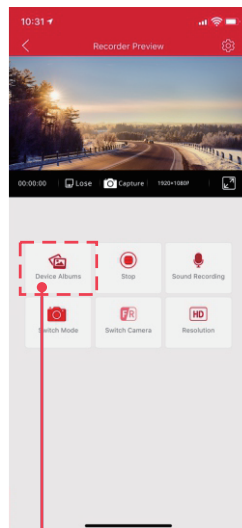

1 Go to Dashcam Preview interface. Please STOP recording first, then press the 'Device Album' to get Photo, Video, Emergency files.

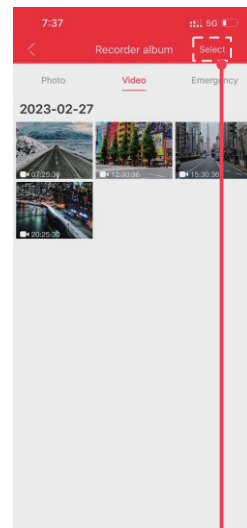

2 Select the video files to download into your smart phone.

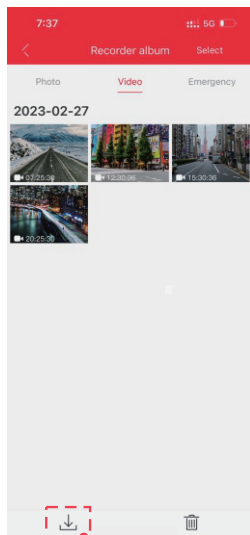

3 Press the icon to download the video files. However, it will take a bit of time to download one video file.

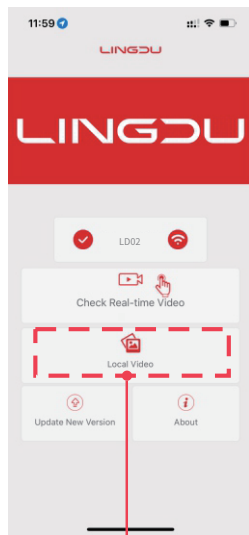

4 Then you can find these downloaded video files in APP original interface menu named 'Local Video'.

The app won't show the live video on your phone. It only shows a picture of the beach?

The cellular data will cause the live video not to be viewed. If the APP won't show the live video, please disable the 'LINGDU' cellular data of your phone. Sure that the Local Network of the 'LINGDU' is turned on.

1. For Latest iOS System: Setting→LINGDU→Click 'Wireless Data'→Select 'WLAN'.
2. For Older iOS System: Setting→LINGDU→Disable the 'Cellular Data'.

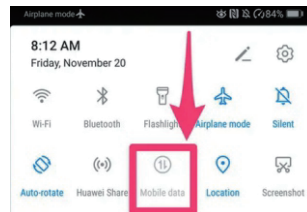
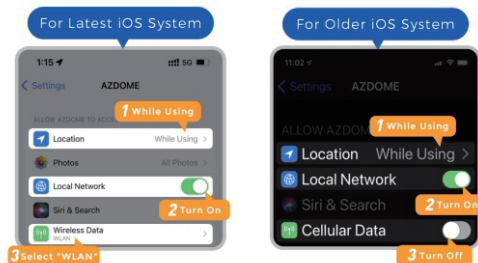



Note:

1. WiFi Direct lets you directly connect your smartphone to your dash cam via WiFi within a range of 10FT.
2. Once it is connected to the LINGDU APP it will automatically update the date/time.
3. The LINGDU is available for devices running Android 5.0 and higher, or iOS 9.0 and higher.

What is a WiFi Feature?

The WiFi feature has been designed so you can pair your dash camera wirelessly with your smartphone and access your recording instantly from the dash cam. Here you can view, download and share your videos easily with your friends and family. Just like how you would connect your Bluetooth speaker to your smartphone for wireless music play, the same way dash cameras use WiFi signal (instead of a Bluetooth) to pair your smartphone with LINGDU V620.

Can I watch the videos around my car remotely?

NO. LINGDU V620 dash cam is NOT made to broadcast footage over the cloud or internet. It is NOT a cloud or an IP camera and it is NOT meant to do that. You can get live video and footage on LINGDU dash cam's APP as long as you stay within the 10FT range from the dashcam.

What is the WiFi Range?

The WiFi signal range is about 10FT when there are NO obstructions in the middle. Please NOTE that just like your home WiFi network, you don't have WiFi signal outside your home, the same way, WiFi range is 10FT from this small device.

For Android phones:

When installing the LINGDU APP, it will have two pop-up prompts, select 'While using the APP' to allow LINGDU to access this device's location, and select 'Allow' to allow LINGDU to access photos and media on your device. There is one extra step you will have to take for the first time. Once you connect to the WiFi of V620, it will say 'No Internet'. Which is fine. Wait about 10-15 seconds until you see the below pop up or notification. You just have to tap on the pop up notification that will show up in few seconds to select that you still want to stay connected even though there is NO Internet. Once you select this OK, you are set to go.

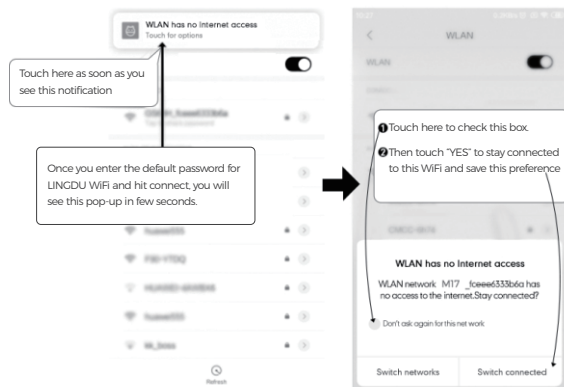

iPhone:

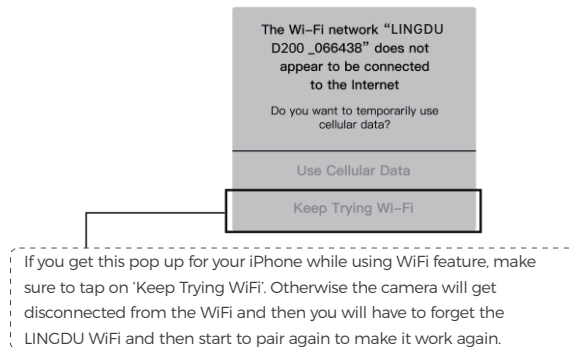

8.3 Calibrate Date/Time

USA Time Zones	When Daylight Savi-ngs Ends Nov - March	When Daylight Savi-ngs Begins March - Nov
Hawaii	GMT (-10:00)	
Alaska	GMT (-9:00)	GMT (-8:00)
Pacific Time Zone	GMT (-8:00)	GMT (-7:00)
Mountain Time Zone	GMT (-7:00)	GMT (-6:00)
Central Time Zone	GMT (-6:00)	GMT (-5:00)
Eastern Time Zone	GMT (-5:00)	GMT (-4:00)
UK Time Zones	British Summer Time	British Winter Time
	GMT/UTC +1	GMT/UTC ±0

8.4 Format Micro-SD Card

There are two ways to format Micro-SD card

1. Press and hold WiFi button for 8 seconds to format and default settings, you will hear sound "di" when format successfully.
2. Please connect to LINGDU APP, using the function menu named "Format" to do.

9. General Setting

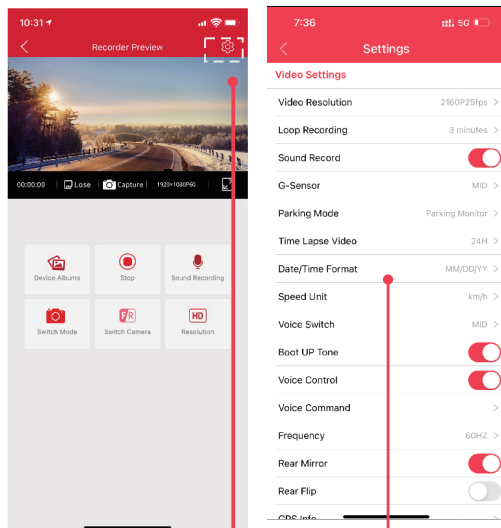

1 Go to Dashcam Preview interface. Please STOP recording first, then press the settings icon.

2 Select what you need to set.

9.1 Video Settings

Video Resolution— : 2560*1440P 30fps+1920*1080P 30fps (Default)

Allow to choose the desired video resolution and fps(frames per second). Higher resolution and fps videos result in smoother videos, but also take more storage space.

Loop Video Clip Time – 1min/ 3mins(Default)/ 5mins

Here select the length(1/3/5 min) of each video clip for the loop recording. This function allows the dash cam to continuously record. Please notice: The dash cam will keep deleting the oldest files automatically when memory card gets full so that it can keep recording over and over.

Audio Recording – On(Default)/Off

The dashcam has built-in microphone to record audio with video. You can choose to record mute video by choosing OFF.

G-Sensor – Off/ Low/ MID(Default)/ High

G-sensor is a 3-axis impact gravitational accelerometer, designed to detect physical and gravitational forces on the dash cam. Once G-sensor has been triggered due to physical or gravitational impact force on the camera, the current video file will be locked as an emergency file so it won't be deleted by loop cycle function. The higher the G-Sensor sensitivity is, the less force will be needed to trigger automatic file protection.

Parking Monitorin

This function will ONLY work when 3-Lead Hardwire Kit is installed properly, the output current of Hardwire Kit needs to reach 2.5A. Then select parking mode. This parking mode has two options to choose from.



Note:

1. Please download and update the latest firmware from the manual
2. Custom-designed Type-C 3-Lead Hardwire Kit is required to use this new feature. Not included in the packaging, on Amazon search: **Type-C 3-Lead Hardwire Kit for D200 Dash Cam**

* Time-Lapse Parking Mode

1. When you turn OFF the car's engine and turn the key to the lock position. Then the camera will STOP the continuous video recording and it will go into the timelapse 1fps recording mode automatically.
2. Now while this timelapse is being recorded, if someone hits your car and if the impact reaches the set G-Sensor level, then the camera will start to record 1-min continuous video, save & lock that video in Event folder > then return to the timelapse 1fps recording.
3. Now when you start your car for the next time, the camera will automatically STOP the timelapse parking mode. Then it will go into normal video mode automatically to start the continuous video recording.

* Collision Detection Parking Mode

1. When you turn OFF the car's engine and turn the key to the lock position. Then the camera will STOP the continuous video recording and it will go into the impact detection mode and the camera will turn OFF.
2. Now while the camera stays in impact detection mode, if someone hits your car and if the impact reaches the set G-Sensor level, then the camera will turn ON > then it will start to record 1-min continuous video, save & lock that video in Event folder > then the camera will turn OFF.
3. Now when you start your car for the next time, the camera will automatically go back into normal video mode automatically to start the continuous video recording.

Time-Lapse Parking Mode Working Time

This setting allows you to choose the Working Time of Time-Lapse Parking Mode.

Fatigue Driving Reminder— Off(Default)/ 2H

When you activate this feature, the dash cam will beep every 2 hours to remind you if you are experiencing fatigue while driving.

Screen Save— Screen Saver Off(Default)/ Screen Off After 1-Min

Screen Saver Off: This screen will always be on.

Screen Off After 1-Min: The screen will turn off after 1 minute of inactivity.

Volume — Off/ Low/ MID(Default)/ High

This feature allows you to set the volume level for the boot sound volume, prompt volume through camera's internal built-in speaker.

Boot Ringtone — On(Default)/ Off

This feature allows you to turn ON/OFF the camera's Boot Ringtone.

Voice Control — On(Default)/ Off

ONLY support English: turn on WiFi, take picture, turn off recording, turn off WiFi, open recording, lock the video

Voice Command

Say a command, but ONLY support English

- To turn on WiFi, say **Turn on WiFi**
- To take a picture, say **Take picture**
- To stop recording, say **Turn off recording**
- To turn off WiFi, say **Turn off WiFi**
- To start recording, say **Open Recording**
- To lock the current video files, say **Lock the video**

Frequency – 50HZ/ 60HZ(Default)

Here you should choose the frequency accordingly to your power supply specification used in your country based on your geographical location.

Rear Mirror

This feature works only on the rear camera image.

On: The image of the rear camera is as same as in the rear mirror, what's on the left in reality-> it's on the right of the dash cam screen;

Off: The rear camera image is as same as what you see, what's on the left in reality- it's on the left of the dash cam screen.

Rear Mirror

This feature works only on the rear camera image.

On: The image of the rear camera is as same as in the rear mirror, what's on the left in reality-> it's on the right of the dash cam screen;

Off: The rear camera image is as same as what you see, what's on the left in reality- it's on the left of the dash cam screen.

Date/Time Format

This feature allows you to select the date format.

Time Zone

-UTC/GMT -7:00 (Default)

-UTC/GMT -12:00 to UTC/GMT +12:00

Here you can choose your desired or local time zone setting based on UTC/GMT value. Please make sure to adjust time zone setting, please refer to page EN-22

Go to <https://www.timeanddate.com/time/map/> to find out your Correct GMT (Greenwich Mean Time) value.

Speed Unit – km/h/MPH(Default)

You can choose desired speed option stamp to be displayed and recorded on video stamp based on your selection.

GPS Information

Check the satellite number / Longitude / Latitude / Speed.

SD Card Information

Storage information of memory card can be found here.

SD Card Information

Storage information of memory card can be found here.

9.2 Video Stamps

Turn On/Off the LINGDU logo / Date/Time / Live-speed / GPS Coordinates Stamp shown on recorded files separately.

9.3 System Setting

WiFi

Here you can change the WiFi Password in APP, the default password: 12345678.

Format SD Card

The formatting process will make sure that the card's file system format is optimized for the camera.

Note: For stable performance, it is recommended that you format the memory card every 1-2 months.

Default Settings

Reset the Dash Cam to default settings. Your recordings will not be affected.

APP Version

Here you can check the current APP version installed on your phone.

Firmware Version

Here you can check the current firmware version installed on your camera. You will need this information in the future to check if newer version of firmware is available.

10. Playing Video Files Using Your Computer

1. Remove the microSD card from the dashcam.
2. Insert the card into a microSD card reader and connect it to your computer.

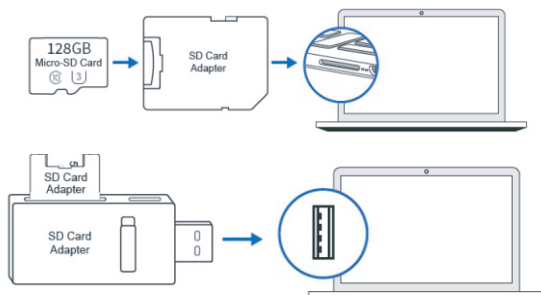

3. Download LINGDU GPS Player from www.lingdu.us > Support > Downloads and install it on your computer.
4. Install the LINGDU GPS Player on your computer. (Note: Please close or ignore the prompt of the anti-virus software, we confirm that it will not bring any security impact to your computer.)
5. You can click the 'Open Files' button to browse and select the Movie or Lock folder of the microSD card on the LINGDU GPS Player. It will show all files in the Video or Event or Photo folder. Or you can also drag the video files directly to the launcher screen.
6. There are two ways to play video.
 - A. Click File-Open icon to choose the folder which you want to play, click to start play. (Note that you can ONLY select one folder to play and see no video files)

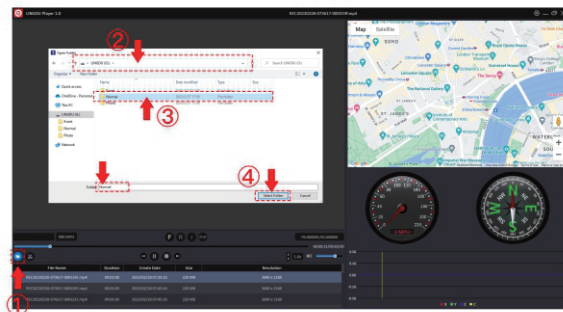

B. Select from 'My Computer' and find the memory card disk, choose the video file you want to play, you can drag and drop the file directly to the player. You can get the GPS information on the player.

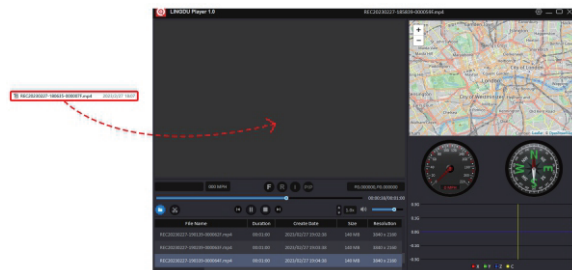

11. Firmware Update

1. Remove the microSD card from the dashcam.
2. Insert the card into the microSD card reader and connect it to a computer.

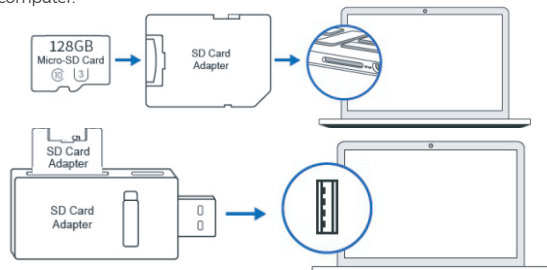

3. Download the latest V620 Firmware from www.lingdu.us > Support > Downloads on your computer.
4. Unzip the downloaded firmware (Zip file) and copy the firmware file "SigmastarUpgradeSD.bin" to the root directory of microSD card.
5. Connect the camera to the car charger to start the firmware update process. You should see the upgrade progress bar and red light will be solid which means your V620 dash camera is updating the new firmware.

Please NOTE:

The firmware update may take up to about 1 mins. So please be patient. Make sure the POWER does NOT get disconnected while the firmware is being updated. Once the firmware is updated, the camera will turn ON automatically.

6. You check the latest firmware version by going into the menu > Firmware Version.

12. Voice Prompts

Prompt Voice	Description
WiFi is on	Default ON, after powered on, say it
WiFi is off	press and hold Wi-Fi button for 3s to switch off, say it
Recording Started	after powered on and boot ringtone/operate via App, say it
Recording Stopped	operate via App, say it
Emergency video	during recording once G-Sensor triggered/shortly press Wi-Fi button one (1) time to lock current video, say it
Audio on	default ON, shortly press two (2) times/operate via App, say it
Audio off	shortly press two (2) times/operate via App, say it
Format Successful	operate via App, say it
Format failed, please try again	formatting unsuccessful, say it
WiFi is Connected	after connected to App, say it
WiFi is Disconnected	quit out App, say it
Please insert TF card	if no card inserted, say it every 30s
Memory card error	wrong/bad/fake memory card or memory card error, say it
(Photograph)	take picture(s) via App, say it
Firmware is updating, please DO NOT turn off the camera	FW updating starts and in progress, say it

Prompt Voice	Description
Formatting TF card, please DO NOT disconnect the power	operate via APP format TF card, say it
Parking mode is on	set Parking Mode on via App (prerequisite: connected Hardwire Kit), say it
Parking mode is OFF	set Parking Mode off via App (prerequisite: connected Hardwire Kit), say it
Parking mode was activated while parking	if parking monitor activated and generated locked file(s) during parking, turn on car again, say it
Factory reset	operate via App, say it

13. FAQ

Q1: Camera turns ON / OFF automatically?

Ensure that the output current can reach 5V/2.5A and use our car charger. And ensure that the rear camera are connected correctly. It is to improve stability that the dashcam reboots automatically once if it detects that there are different cameras connected.

Q2: Video Image is blurred?

Remove the protective lens film, clean the lens, make sure the windshield is clean and clear of grease, dirt, and debris.

Q3: Camera gets HOT?

It is normal for your camera to run slightly hot. Due to video being recorded at high speed, the dash cam may be hot during using.
(No more than 158°F/70°C).

Q4: No power to my Dash Cam but it works upon my computer?

The cigarette power cable is not working. Inspect the fuse in the Car Power Cable plug. If the fuse is found to be blown, inspect the power cable for damage which may have caused the fuse to blow.

Q5: The sound is not synchronised with video during playback?

The Codecs upon your PC may not be compatible or the latest standard. Download the latest LINGDU GPS Player from www.lingdu.us > Support > Downloads.

Q6: Video Files cannot be played on my computer?

The video files from the Dash Cam are in MP4 format and may not be compatible with your PC if suitable playback software is not installed.

Q7: Video has no sound?

Ensure that 'Record Audio' setting is turned ON. Ensure that 'Timelapse

Record' setting is turned OFF with in the APP Menu

Q8: Video is blurred?

The Dash Cam has a minimum focal range of around 2 meters.

Objects closer than this are likely to become blurred.

Q9: Voice prompt Memory Error?

Using unqualified SD or third party cards can affect dashcam's performance and in some cases, force the dashcam to reboot randomly during recording. If it still can not work normally, it should be that the TF card is unqualified and can not meet the recording requirements of the dash cam. Please contact us to get a new memory card.

14. Notice

 This product complies with the radio interface requirements of the European Community.

 This symbol means the product must not be discarded as household waste, and should be delivered to an appropriate and recycling helps protect natural resources, human health and the environment. For more information on disposal and recycling of this product, contact your local municipality, disposal service, or the shop where you bought this product.

 Changes or modifications not expressly approved by the party responsible for compliance could void the user's authority to operate the equipment.

This equipment has been tested and found to comply with the limits for a Class B digital device, pursuant to Part 15 of the FCC Rules. These limits are designed to provide reasonable protection against harmful interference in a residential installation. This equipment generates, uses and can radiate radio frequency energy and, if not installed and used in accordance with the instructions, may cause harmful interference to radio communications. However, there is no guarantee that interference will not occur in a particular

If this equipment does cause harmful interference to radio or television reception, which can be determined by turning the equipment off and on, the user is encouraged to try to correct the interference by one or more of the following measures:

- Reorient or relocate the receiving antenna.
- Increase the separation between the equipment and receiver.
- Connect the equipment into an outlet on a circuit different from that to which the receiver is connected.
- Consult the dealer or an experienced radio/TV technician for help.

This device complies with Part 15 of the FCC Rules. Operation is subject to the following two conditions: (1) this device may not cause harmful interference, and (2) this device must accept any interference received, including interference that may cause undesired operation. This equipment complies with FCC radiation exposure limits set forth for an uncontrolled environment. This equipment should be installed and operated with a minimum distance of 20cm between the radiator & your body. This transmitter must not be co-located or operating in conjunction with any other antenna or transmitter.